



**IF YOU HAVE ANY QUESTIONS OR CONCERNS, OR ARE MISSING PARTS
DO NOT RETURN TO THE STORE!**

PLEASE CALL OUR CONSUMER HOTLINE AT 1-800-253-4642

INSTRUCTION MANUAL FOR 65HR8

LIMITED WARRANTY

Root-Lowell Manufacturing Company warrants to the original purchaser only that this product will continue to function as intended if used in accordance with the operating instructions (under NORMAL CONSUMER USE) for one year. If the product fails to function as intended--DO NOT RETURN IT TO THE STORE--call our CONSUMER SERVICE HOTLINE at 1-800-253-4642 (toll free) for fast service. We will, at our option, repair or replace any non-functioning parts without charge (*shipping and handling charges will apply*). Root-Lowell Manufacturing Company shall have the option of requiring the return of the non-functioning product together with the proof of purchase to establish a claim under this warranty. This warranty does not apply to damage resulting from accident, misuse, neglect, alterations, operation not in accordance with instructions, commercial use or normal wear.

ANY IMPLIED WARRANTIES, INCLUDING THE IMPLIED WARRANTY OF MERCHANTABILITY AND FITNESS FOR CONSUMER USE, ARE LIMITED TO THE DURATION SPECIFIED ABOVE. ROOT-LOWELL MANUFACTURING COMPANY'S LIABILITY IS LIMITED SOLELY TO THE REPAIR OR REPLACEMENT OF THE NON-FUNCTIONING PRODUCT OR PART. ROOT-LOWELL MANUFACTURING COMPANY EXCLUDES LIABILITY UNDER THIS WARRANTY FOR ANY AND ALL INCIDENTAL AND CONSEQUENTIAL LOSS OR DAMAGE.

Some states do not allow limitations on how long an implied warranty lasts, or the exclusion or limitation of incidental consequential damages, so these limitations or exclusions may not apply to you. This warranty gives you specific legal rights and you may have other rights which vary from state to state.

INTRODUCTION

This hose reel has been manufactured from high quality materials and the most suitable components. The system winds the hose in automatically, using a spring drive. An automatic gripping mechanism allows the automatic winding system to be locked so that the length of unwound hose can be adjusted. An automatic alignment device ensures that the hose winds onto the reel correctly. The wall mounting bracket allows the hose reel to pivot 180 degrees for ease of use. The high-quality hose is capable of a high rate of flow at high pressure.

ATTENTION: BEFORE USE

PLEASE NOTE:

- The hose is NOT suited for drinkable water.
- Only factory trained professionals should attempt to open the cover on the hose reel.
- Please CAREFULLY read the instructions before use.

PARTS LIST

HOSE and REEL (1 each)

SPRAY NOZZLE (1 each)

MOUNTING BRACKET (1 each)

METAL BRACKET PIVOT TUBE (1 each)

EXPANSIVE BOLTS (set of 4)

TOOLS NEEDED FOR INSTALLATION

1. POWER DRILL

2. 1/2" MASONRY DRILL BIT

3. 1/2" SOCKET WRENCH

INSTALLATION

This Hose and Reel is suitable for installation close to a water supply. The distance from the faucet to the Hose and Reel can be extended by adding an additional length of hose.

When installed to a wall or post, follow these steps:

1. Attach the spray nozzle to longer, retractable hose.
2. Install mounting bracket to the wall or post as in FIG. 1. The wall mounting may be attached to a stone or brick wall. If attaching to a wood surface, lag bolts (not included) are needed. There are many alternative positions in which the equipment may be placed. The important thing is to locate the hose where it is most convenient for the user. The wall mounting has 4 holes, one each taking an expansive bolt. Each bolt must be fitted with a flexible washer or cushioning piece.
3. Connect the reel to the mounting bracket with the metal tube (pin).
4. Attach the brass connection on the leader hose to the faucet or water tap.



FIG. 1

ADDITIONAL PRECAUTIONS WHEN USING THE HOSE AND REEL

The Hose and Reel comes with a high-quality, UV-protected, kink-resistant hose. After use, turn off the water supply, empty out the water remaining in the hose by opening the valve on the nozzle. Gently tug on the hose to begin retracting the hose onto the reel. In certain areas where the temperatures or water pressures are high, the sunlight may heat up the water and damage the hose, making the hose difficult to reel in. You are therefore advised always to reel in your hose after use. Do not leave the hose reel outdoors when temperatures are below 32 degrees. In such conditions, the hose may be less flexible and more difficult to reel in. The hose should never come in contact with chemicals or other substances such as acetone, mineral spirits, acids, etc. *Please note that the hose supplied with this hose reel should never be used for drinking water.*

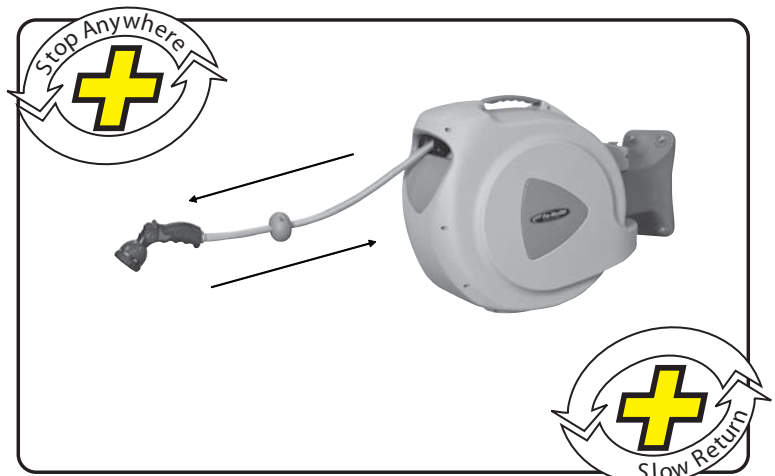

HOW TO USE THE HOSE AND REEL



This Hose and Reel contains a mechanical, spring-assisted winding system that enables the hose to be reeled in and out easily. When pulling out the hose to the length needed, stop pulling, and the hose will be locked into position automatically. To return the hose to the reel, tug gently and the hose will be retracted automatically. If you pull out the hose and stop pulling again, the hose will be locked into position. To have the best retraction, it is suggested to have a minimum 25% of the hose extended. To ensure smooth operation, pull out the hose to the yellow warning mark, and then retract it, which can smooth the hose and let it evenly retract back to the reel.



WARNING! Always hold the hose until it is completely retracted to the reel. When the hose is pulled out to the warning mark (3 feet from the end), do not pull the hose with great strength. Do not hold hose tightly when retracting the hose.

MAINTENANCE

Do not immerse the hose and reel in water to clean it. If the hose is very dirty, clean it with water and a cloth before reeling it in. You are advised to mount the hose and reel in the shade in order to extend its life. If left in an exposed situation, the metal parts may deteriorate and rust. Even the polypropylene parts may be affected if they are left outside, particularly if exposed to sunlight, which may shorten the life of the hose reel casing and the winding reel.

If outside temperatures drop below 32 degrees, the hose may also be damaged, particularly if it is full of water. You are advised to store your hose reel indoors in a clean, dry place when not in use.

TROUBLE SHOOTING

The most common malfunction of this kind of product is the hose cannot be retracted automatically after fully pulled out. The reason for this may be that the hose end is locked as the stop anywhere mechanism stays in that locking point and there is no extra hose to be pulled out for release. There are two ways to solve this:

1. Hold the hose at the yellow warning mark and pull the hose with greater strength until it can be retracted.
2. Place the item with its right side down, pull out the hose until it can be retracted.



Root-Lowell Manufacturing Co.
1000 Foreman Rd.
P.O. Box 289
Lowell, MI 49331

Consumer Service 1-800-253-4642
Year Round: Monday - Friday, 8 a.m. to 7 p.m., ET
March 1 - August 31: Monday - Friday, 8 a.m. to 7 p.m., ET
Saturday & Sunday, 10 a.m. to 4 p.m., ET